

# WOOD DESTROYING PESTS AND ORGANISMS INSPECTION REPORT

Building No. 1065	Street Colorado ave.	City Chula Vista	ZIP 91910	Date of Inspection 12/20/2021	Number of Pages 7
----------------------	-------------------------	---------------------	--------------	----------------------------------	----------------------



**The Works Termite Inc**  
**1101 Bay Blvd #B**  
 Chula Vista CA 91911  
 (619) 987-2504  
 theworkstermite@yahoo.com

Report # : 16915  
 Registration # : PR7066  
 Escrow # :  
☐ CORRECTED REPORT

Ordered by: Ramon Maldonado Sotheby's Realty 1111 Prospect st. La Jolla CA 92037 United States MOBILE: (619) 791-9226 ramon@ramonsells.com	Property Owner and/or Party of Interest:	Report sent to:
---	--	-----------------

COMPLETE REPORT ☒
 LIMITED REPORT ☐
 SUPPLEMENTAL REPORT ☐
 REINSPECTION REPORT ☐

GENERAL DESCRIPTION: One-story single family residence, stucco, composition roof, vacant, detached garage and granny flat.	Inspection Tag Posted: Attic Other Tags Posted: None
---	---

An inspection has been made of the structure(s) shown on the diagram in accordance with the Structural Pest Control Act. Detached porches, detached steps, detached decks and any other structures not on the diagram were not inspected.

Subterranean Termites ☒
 Drywood Termites ☒
 Fungus / Dryrot ☒
 Other Findings ☐
 Further Inspection ☐

If any of the above boxes are checked, it indicates that there were visible problems in accessible areas. Read the report for details on checked items.

**Diagram Not To Scale**

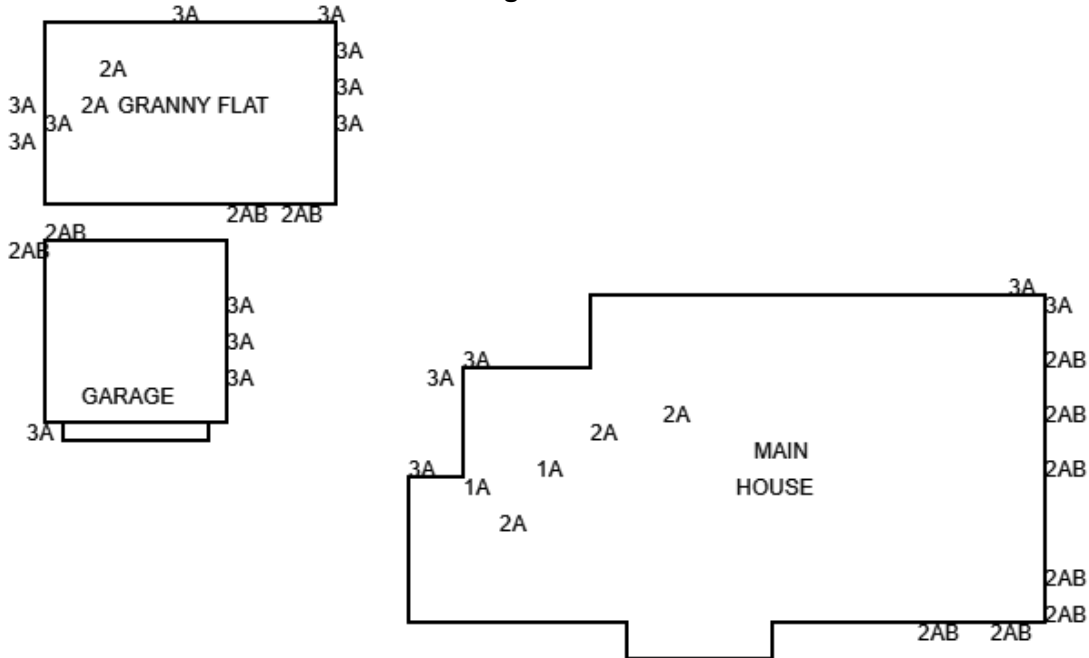

Inspected By: Guillermo Nunez
 State License No. OPR10701
 Signature:

# THE WORKS TERMITE INC

Page 2 of 7 inspection report

1065	Colorado ave.	Chula Vista	CA	91910
Address of Property Inspected		City	State	ZIP
12/20/2021	16915			
Date of Inspection		Corresponding Report No.		Escrow No.

**WHAT IS A WOOD DESTROYING PEST & ORGANISM INSPECTION REPORT? READ THIS DOCUMENT. IT EXPLAINS THE SCOPE AND LIMITATIONS OF A STRUCTURAL PEST CONTROL INSPECTION AND A WOOD DESTROYING PEST & ORGANISM INSPECTION REPORT.**

A Wood Destroying Pest & Organism Inspection Report contains findings as to the presence or absence of evidence of wood destroying pests and organisms in visible and accessible areas and contains recommendations for correcting any infestations or infections found. The contents of Wood Destroying Pest & Organism Inspection Reports are governed by the Structural Pest Control Act and regulations.

Some structures do not comply with building code requirements or may have structural, plumbing, electrical, mechanical, heating, air conditioning or other defects that do not pertain to wood destroying organisms. A Wood Destroying Pest & Organism Inspection Report does not contain information on such defects, if any, as they are not within the scope of the licenses of either this company, or it's employees.

The Structural Pest Control Act requires inspection of only those areas which are visible and accessible at the time of inspection. Some areas of the structure are not accessible to inspection, such as the interior of hollow walls, spaces between floors, areas concealed by carpeting, appliances, furniture or cabinets. Infestations or infections may be active in these areas without visible and accessible evidence. If you desire information about areas that were not inspected, a further inspection may be performed at an additional cost. Carpets, furniture PORTIONS OF THE ATTIC CONCEALED OR MADE INACCESSIBLE BY INSULATION PORTIONS OF THE ATTIC CONCEALED OR MADE INACCESSIBLE BY DUCTING, PORTIONS OF THE ATTIC OR ROOF CAVITY CONCEALED DUE TO AN INADEQUATE CRAWL SPACE, THE INTERIORS OF BOXED EAVES, EAVES CONCEALED BY PATIO COVERS OR OTHER ABUTMENTS PORTIONS OF THE SUBAREA CONCEALED OR MADE INACCESSIBLE BY INSULATION, DUCTING OR INSUFFICIENT CLEARANCE, PORTE COCHERES, INCLOSED BAY WINDOWS, AREAS BENEATH WOOD FLOORS OVER CONCRETE, AREAS CONCEALED BY BUILT-IN CABINET WORK OR BUILT-IN APPLIANCES, AREAS CONCEALED BY FLOOR COVERINGS SUCH AS WALL-TO-WALL CARPETING, LINOLEUM, CERAMIC TILE, AREA RUGS, THROW RUGS, BATH AND KITCHEN MATS ETC. AND AREAS CONCEALED BY BUILT-IN APPLIANCES. WE DO NOT OPEN ANY WINDOWS OR REMOVE WINDOW SCREENS DURING THE COURSE OF OUR INSPECTIONS. UNLESS OTHERWISE SPECIFIED IN THIS REPORT. ADDITIONALLY, WE DO NOT INSPECT ATTACHED/DETACHED FENCES, GATES, SHEDS, DOG HOUSES, RETAINING WALLS WOOD PLANTERS OR WALKWAYS OR AREAS CONCEALED BY HEAVY VEGETATION AND AREAS WHERE LOCKS PREVENTED ACCESS. THESE AREAS WILL BE INSPECTED FOR A FEE, IF THEY ARE MADE ACCESSIBLE AT THE OWNERS EXPENSE or appliances are not moved and windows are not opened during a routine inspection.

**The exterior Surface of the roof was not inspected. If you want the water tightness of the roof determined, you should contact a roofing contractor who is licensed by the Contractor's State License Board.**

This company does not certify or guarantee against any leakage, such as (but not limited to) plumbing, appliances, walls, doors, windows, any type of seepage, roof or deck coverings. This company renders no guarantee, whatsoever, against any infection, infestation or any other adverse condition which may exist in such areas or may become visibly evident in such area after this date. Upon request, further inspection of these areas would be performed at an additional charge.

In the event damage or infestation described herein is later found to extend further than anticipated, our bid will not include such repairs. OWNER SHOULD BE AWARE OF THIS CLOSED BID WHEN CONTRACTING WITH OTHERS OR UNDERTAKING THE WORK HIMSELF/HERSELF.

If requested by the person ordering this report, a re-inspection of the structure will be performed. Such requests must be within four (4) months of the date of this inspection. Every re-inspection fee amount shall not exceed the original inspection fee.

Wall paper, stain, or interior painting are excluded from our contract. New wood exposed to the weather will be prime painted, only upon request at an additional expense.

This company will reinspect repairs done by others within four months of the original inspection. A charge, if any, can be no greater than the original inspection fee for each reinspection. The reinspection must be done within ten (10) working days of request. The reinspection is a visual inspection and if inspection of concealed areas is desired, inspection of work in progress will be necessary. Any guarantees must be received from parties performing repairs.

NOTICE: Reports on this structure prepared by various registered companies should list the same findings (i.e. termite

# THE WORKS TERMITE INC

Page 3 of 7 inspection report

1065	Colorado ave.	Chula Vista	CA	91910
Address of Property Inspected		City	State	ZIP
12/20/2021	16915			
Date of Inspection	Corresponding Report No.		Escrow No.	

infestations, termite damage, fungus damage, etc.). However, recommendations to correct these findings may vary from company to company. You have a right to seek a second opinion from another company.

This Wood Destroying Pest & Organisms Report DOES NOT INCLUDE MOLD or any mold like conditions. No reference will be made to mold or mold-like conditions. Mold is not a Wood Destroying Organism and is outside the scope of this report as defined by the Structural Pest Control Act. If you wish your property to be inspected for mold or mold like conditions, please contact the appropriate mold professional.

# THE WORKS TERMITE INC

Page 4 of 7 inspection report

1065	Colorado ave.	Chula Vista	CA	91910
Address of Property Inspected		City	State	ZIP
12/20/2021	16915			
Date of Inspection		Corresponding Report No.		Escrow No.

SECTION I CONTAINS ITEMS WHERE THERE IS EVIDENCE OF ACTIVE INFESTATION, INFECTION OR CONDITIONS THAT HAVE RESULTED IN OR FROM INFESTATION OR INFECTION OF SUBTERRANEAN TERMITE/DRYWOOD TERMITE & FUNGUS/DRYROT SECTION II ITEMS ARE CONDITIONS DEEMED LIKELY TO LEAD TO INFESTATION OR INFECTION BUT WHERE NO VISIBLE EVIDENCE OF SUCH WAS FOUND. FURTHER INSPECTION ITEMS ARE DEFINED AS RECOMMENDATIONS TO INSPECT AREA(S) WHICH DURING THE ORIGINAL INSPECTION DID NOT ALLOW THE INSPECTOR ACCESS TO COMPLETE HIS INSPECTION AND CANNOT BE DEFINED AS SECTION I OR II. WE ARE LICENSED TO INSPECT, SUBTERRANEAN TERMITE/DRYWOOD TERMITE & FUNGUS/DRYROT INFESTATION ONLY. NO OPINION, RECOMENDATION OR IDENTIFICATION ON ANY OTHER PEST INFESTATION. THE WORKS TERMITE CO. TO WARRANTY ALL REPAIRS AND OR TREATMENTS FOR ONE YEAR FROM DATE OF COMPLETION EXCEPT FOR CAULKING,GROUTING OR PLUMBING, WHICH IS GUARANTEED FOR A PERIOD OF NINETY(90) DAYS. WE ASSUME NO RESPONSIBILITY FOR WORK PERFORMED BY OTHERS, TO BE BOUND TO PERFORM THIS WORK FOR THE PRICE QUOTED IN OUR COST BREAKDOWN FOR A PERIOD NOT TO EXCEED 30 DAYS, TO USE REASONABLE CARE IN THE PERFORMANCE OF OUR WORK BUT TO ASSUME NO RESPONSIBILITY FOR DAMAGE TO ANY HIDDEN PIPES, WIRING, OR OTHER FACILITIES OR TO ANY SHRUBS, PLANTS OR ROOF. (THE SECOND/OR MORE STORY EAVE IS CONSIDERED INACCESSIBLE DUE TO HEIGHT)

## 1. SUBTERRANEAN TERMITES:

### 1A - Section I

FINDINGS - Evidence of subterranean termite infestation noted at subarea.

RECOMMENDATION - Chemically treat the soil at probable termite entry for control of suterranean termites. This may include: rodding or trenching around the foudation walls, piers & plumbing pipes in the subarea and exterior foundation or drilling attached slabs, brick or stone veneer below grade level, treating voids in foudation walls or piers. Remove termite shelter tubes (if present) from accessible areas. LOCAL TREATMENT WILL BE WARRANTY FOR 1 YEAR FROM DATE OF COMPLETION.

## 2. DRYWOOD TERMITES:

### 2A - Section I

FINDING - Evidence of Drywood termite infestation noted at Attic AND EXTERIOR.

RECOMMENDATION - Fumigate the entire structure (VIKANE - SULFURYL FLOURIDE) for the complete eradication of drywood termites. Remove or cover drywood termite fecal pellets in accessible areas. Owner/agent to prepare for fumigation as per list of instructions to be furnished by The Works Termite Inc.. The structure must be vacated for 3 days until released for re-entry by the licensed fumigator.\*\*\*\*Elite Fume Inc. will be sub contracted for the Fumigation which will also have a warranty of 3 years.\*\*\*\*It is the owner/agents responsibility to call SDG&E (1 800 411-7343) to make an appointment to turn on the gas service. WARRANTY ON TILE ROOF INCLUDED.

### 2B - Section I

FINDING - Evidence of Drywood termite damage noted at Exterior of house.

RECOMMENDATION - Remove and replace drywood termite infested/damaged wood members with today standard industry sizes, Cosmetic damage will be patched with BONDO as needed (Paint to color all repaired areas, NO warranty on color match, 1 paint coat only) (No Roofing repairs included with this bid and may required an additional cost). If Damage or infestations are found to extend into interior of wall void or other inaccessible areas it will be reported on a supplemental report. Estimate on additional repairs/treatment will be given. No opinion rendered at this time. Treat for the control of drywood termites as needed per this report. ALL REPAIR/TREATMENT WILL BE WARRANTY FOR ONE YEAR FROM DATE OF COMPLETION.

## 3. FUNGUS / DRYROT:

### 3A - Section I

FINDING - Evidence of Fungus/Dryrot damage noted at Exterior of house.

RECOMMENDATION - Remove fungus damage wood member(s) and replace with new material with today industry wood standard size. Cosmetic damage will be patched with BONDO as needed. Treat adjacent wood members with a registered

# THE WORKS TERMITE INC

Page 5 of 7 inspection report

1065	Colorado ave.	Chula Vista	CA	91910
Address of Property Inspected		City	State	ZIP
12/20/2021	16915			
Date of Inspection	Corresponding Report No.	Escrow No.		

fungicide or wood preservative. (paint to color all repaired areas, NO warranty on color match, 1 paint coat only). If Damage or infestations are found to extend into interior of wall void or other inaccessible areas it will be reported on supplemental report. Estimate on additional repairs/treatment will be given. No opinion rendered at this time. ALL WOOD REPAIR/TREATMENT WILL BE WARRANTY FOR ONE YEAR FROM DATE OF COMPLETION.

"Thank you for selecting our company to perform a structural SUBTERRANEAN TERMITE/DRYWOOD TERMITE & FUNGUS/DRYROT control inspection on your property. Our inspectors have determined that your property will benefit from the safe application of a chemical commonly used for structural pest control. In accordance with the laws and regulations of the State of California, we are required to provide you and your occupants with the following information prior to any application of chemicals to such property. Please take a few moments to read and become familiar with the content. \*\*\*\*\*OCCUPANTS CHEMICAL NOTICE\*\*\*\*\* The Works Termite Inc. will use pesticide chemical(s) specified below for the control of wood destroying pests or organisms in locations identified in the Structural Pest Control report as indicated above. (1) The pest(s) to be controlled: \_\_\_\_ SUBTERRANEAN TERMITE \_\_\_\_ DRYWOOD TERMITE \_\_\_\_ FUNGUS/DRY ROT . \_\_\_\_ OTHER (2) The pesticide(s) proposed to be used and the active ingredient(s): \_\_\_\_A. TERMIDOR (FIPRONIL 9.1% INERT INGREDIENTS 90.9%) \_\_\_\_B. TIMBOR (DISODIUM OCTABORATE TETRAHYDRATE) \_\_\_\_C. COPPER (NAPHTHENATE (COPPER SALTS OF NAPHTHENIC ACIDS) \_\_\_\_D. PREMISE (IMIDACLOPRID 0.5% INERT INGREDIENTS 99.5) \_\_\_\_E. VIKANE (SULFURYL FLUORIDE 99.8% INERT INGREDIENTS 0.2%) Persons with respiratory or allergic conditions, or others who may be concerned about their health relative to this chemical treatment, should contact their physician concerning occupancy during and after chemical treatment prior to signing this NOTICE. NO CHEMICAL APPLICATION WILL BE PERFORMED UNTIL SUCH TIME THAT THIS NOTICE IS RETURNED. HAVING READ THE INSTRUCTIONS, I, THE UNDERSIGNED, WILL ACCEPT RESPONSIBILITY FOR ALL THE AFOREMENTIONED.

\_\_\_\_ owner/occupant date  
\_\_\_\_ owner/occupant date State Law requires that you be given the following information: ""CAUTION - PESTICIDES ARE TOXIC CHEMICALS. Structural Pest Control Operators are licensed and regulated by the Structural Pest control Board, and apply pesticides which are registered and approved for use by the California Department of Food and Agriculture and the United States Environmental Protection Agency. Registration is granted when the state finds that based on scientific evidence, there are no appreciable risks weighted by the benefits. The degree of risk depends on the degree of exposure, so exposure should be minimized."" ""If within 24 hours following application, you experience symptoms similar to common seasonal illness comparable to the flu, contact your physician or poison control center and your pest control operator immediately."" The Works termite Inc. .... 619-987-2504 County Health Department ..... 619-338-2222 County Poison Control Center ..... 800-876-4766 County Agricultural Commissioner ..... 619-694-2739 Structural Pest Control Board ..... 916-561-8708 or 800-737-8188 (2005 EVERGREEN ST, SUITE 1500, SACRAMENTO, CALIFORNIA 95815.) THE WORKS TERMITE INC. TO WARRANTY ALL WOOD REPAIR/TREATMENT FOR ONE YEAR FROM DATE OF COMPLETION EXCEPT FOR CAULKING, GROUTING OR PLUMBING, WHICH IS WARRANTY FOR A P"Thank you for selecting our company to perform a structural SUBTERRANEAN TERMITE/DRYWOOD TERMITE & FUNGUS/DRYROT control inspection on your property. Our inspectors have determined that your property will benefit from the safe application of a chemical commonly used for structural pest control. In accordance with the laws and regulations of the State of California, we are required to provide you and your occupants with the following information prior to any application of chemicals to such property. Please take a few moments to read and become familiar with the content. \*\*\*\*\*OCCUPANTS CHEMICAL NOTICE\*\*\*\*\* The Works Termite Inc. will use pesticide chemical(s) specified below for the control of wood destroying pests or organisms in locations identified in the Structural Pest Control report as indicated above. (1) The pest(s) to be controlled: \_\_\_\_ SUBTERRANEAN TERMITE \_\_\_\_ DRYWOOD TERMITE \_\_\_\_ FUNGUS/DRY ROT . \_\_\_\_ OTHER (2) The pesticide(s) proposed to be used and the active ingredient(s): \_\_\_\_A. TERMIDOR (FIPRONIL 9.1% INERT INGREDIENTS 90.9%) \_\_\_\_B. TIMBOR (DISODIUM OCTABORATE TETRAHYDRATE) \_\_\_\_C. COPPER (NAPHTHENATE (COPPER SALTS OF NAPHTHENIC ACIDS) \_\_\_\_D. PREMISE (IMIDACLOPRID 0.5% INERT

# THE WORKS TERMITE INC

Page 6 of 7 inspection report

1065	Colorado ave.	Chula Vista	CA	91910
Address of Property Inspected		City	State	ZIP
12/20/2021	16915			
Date of Inspection	Corresponding Report No.	Escrow No.		

INGREDIENTS 99.5) \_\_\_\_E. VIKANE (SULFURYL FLUORIDE 99.8% INERT INGREDIENTS 0.2%) Persons with respiratory or allergic conditions, or others who may be concerned about their health relative to this chemical treatment, should contact their physician concerning occupancy during and after chemical treatment prior to signing this NOTICE. NO CHEMICAL APPLICATION WILL BE PERFORMED UNTIL SUCH TIME THAT THIS NOTICE IS RETURNED. HAVING READ THE INSTRUCTIONS, I, THE UNDERSIGNED, WILL ACCEPT RESPONSIBILITY FOR ALL THE AFOREMENTIONED.

\_\_\_\_owner/occupant date

\_\_\_\_owner/occupant date State Law requires that you be given the following information: ""CAUTION - PESTICIDES ARE TOXIC CHEMICALS. Structural Pest Control Operators are licensed and regulated by the Structural Pest control Board, and apply pesticides which are registered and approved for use by the California Department of Food and Agriculture and the United States Environmental Protection Agency. Registration is granted when the state finds that based on scientific evidence, there are no appreciable risks weighted by the benefits. The degree of risk depends on the degree of exposure, so exposure should be minimized."" ""If within 24 hours following application, you experience symptoms similar to common seasonal illness comparable to the flu, contact your physician or poison control center and your pest control operator immediately."" The Works termite Inc. .... 619-987-2504 County Health Department ..... 619-338-2222 County Poison Control Center ..... 800-876-4766 County Agricultural Commissioner ..... 619-694-2739 Structural Pest Control Board ..... 916-561-8708 or 800-737-8188 (2005 EVERGREEN ST, SUITE 1500, SACRAMENTO, CALIFORNIA 95815.) THE WORKS TERMITE INC. TO WARRANTY ALL WOOD REPAIR/TREATMENT FOR ONE YEAR FROM DATE OF COMPLETION EXCEPT FOR CAULKING, GROUTING OR PLUMBING, WHICH IS WARRANTY FOR A P"Thank you for selecting our company to perform a structural SUBTERRANEAN TERMITE/DRYWOOD TERMITE & FUNGUS/DRYROT control inspection on your property. Our inspectors have determined that your property will benefit from the safe application of a chemical commonly used for structural pest control. In accordance with the laws and regulations of the State of California, we are required to provide you and your occupants with the following information prior to any application of chemicals to such property. Please take a few moments to read and become familiar with the content. \*\*\*\*\*OCCUPANTS CHEMICAL NOTICE\*\*\*\*\* The Works Termite Inc. will use pesticide chemical(s) specified below for the control of wood destroying pests or organisms in locations identified in the Structural Pest Control report as indicated above. (1) The pest(s) to be controlled: \_\_\_\_ SUBTERRANEAN TERMITE \_\_\_\_ DRYWOOD TERMITE \_\_\_\_ FUNGUS/DRY ROT . \_\_\_\_ OTHER (2) The pesticide(s) proposed to be used and the active ingredient(s): \_\_\_\_A. TERMIDOR (FIPRONIL 9.1% INERT INGREDIENTS 90.9%) \_\_\_\_B. TIMBOR (DISODIUM OCTABORATE TETRAHYDRATE) \_\_\_\_C. COPPER (NAPHTHENATE (COPPER SALTS OF NAPHTHENIC ACIDS) \_\_\_\_D. PREMISE (IMIDACLOPRID 0.5% INERT INGREDIENTS 99.5) \_\_\_\_E. VIKANE (SULFURYL FLUORIDE 99.8% INERT INGREDIENTS 0.2%) Persons with respiratory or allergic conditions, or others who may be concerned about their health relative to this chemical treatment, should contact their physician concerning occupancy during and after chemical treatment prior to signing this NOTICE. NO CHEMICAL APPLICATION WILL BE PERFORMED UNTIL SUCH TIME THAT THIS NOTICE IS RETURNED. HAVING READ THE INSTRUCTIONS, I, THE UNDERSIGNED, WILL ACCEPT RESPONSIBILITY FOR ALL THE AFOREMENTIONED.

\_\_\_\_owner/occupant date

\_\_\_\_owner/occupant date State Law requires that you be given the following information: ""CAUTION - PESTICIDES ARE TOXIC CHEMICALS. Structural Pest Control Operators are licensed and regulated by the Structural Pest control Board, and apply pesticides which are registered and approved for use by the California Department of Food and Agriculture and the United States Environmental Protection Agency. Registration is granted when the state finds that based on scientific evidence, there are no appreciable risks weighted by the benefits. The degree of risk depends on the degree of exposure, so exposure should be minimized."" ""If within 24 hours following application, you experience symptoms similar to common seasonal illness comparable to the flu, contact your physician or poison control center and your pest control operator immediately."" The Works termite Inc. .... 619-987-2504 County Health Department ..... 619-338-2222 County Poison Control Center ..... 800-876-4766 County Agricultural Commissioner ..... 619-694-2739 Structural Pest Control Board ..... 916-561-8708 or 800-737-8188 (2005 EVERGREEN ST, SUITE 1500, SACRAMENTO, CALIFORNIA 95815.) THE WORKS TERMITE INC. TO WARRANTY ALL WOOD REPAIR/TREATMENT FOR ONE YEAR FROM DATE OF COMPLETION EXCEPT FOR CAULKING, GROUTING OR PLUMBING, WHICH IS WARRANTY FOR A P

Poison Control Center	(800) 222-1222
Agricultural Department	(858) 694-2739
Health Department	(866) 358-2966

# THE WORKS TERMITE INC

Page 7 of 7 inspection report				
1065	Colorado ave.	Chula Vista	CA	91910
Address of Property Inspected		City	State	ZIP
12/20/2021	16915			
Date of Inspection	Corresponding Report No.		Escrow No.	
Structural Pest Control Board	(916) 561-8700			
	2005 Evergreen Street, Ste. 1500. Sacramento, CA 95815			



**The Works Termite Inc**  
**1101 Bay Blvd #B**  
Chula Vista CA 91911  
(619) 987-2504  
theworkstermite@yahoo.com

Page 1 of 1

## WORK AUTHORIZATION

**Report #: 16915**

**No work will be performed until a signed copy of this agreement has been received.**

Address of Property : 1065 Colorado ave.

City: Chula Vista

State/ZIP: CA 91910

The inspection report of the company dated, **12/20/2021** is incorporated herein by reference as though fully set forth.

The company is authorized to proceed with the work outlined in the items circled below from the Termite Inspection Report for the property inspected, for a total sum of \$ \_\_\_\_\_. This total amount is due and payable within days from completion repair work and/or chemical application.

### THE COMPANY AGREES

To guarantee all repair completed by this company for one year from date of completion except for caulking, grouting, or plumbing, which is guaranteed for a period of **ninety (90) days**. We assume no responsibility for work performed by others, to be bound to perform this work for the price quoted in our cost breakdown for a period not to exceed 30 days, to use reasonable care in the performance of our work but to assume no responsibility for damage to any hidden pipes, wiring, or other facilities or to any shrubs, plants, or roof.

### THE OWNER OR OWNER'S AGENT AGREES

To pay for services rendered in any additional services requested upon completion of work to pay a service charge of one and one-half percent (1 1/2%) interest per month, or portion of any month, annual interest rate of eighteen percent (18%) on accounts exceeding the ten (10) day full payment schedule. The Owner grants to The Company a security interest in the property to secure payment sum for work and inspection fee completed. In case of non-payment by The owner, reasonable attorney fees and costs of collection shall be paid by owner, whether suit be filed or not.

### ALL PARTIES AGREE

If any additional work is deemed necessary by the local building inspector, said work will not be performed without additional authorization from owner or owner's agent. This contract price does not include the charge of any Inspection Report fees. Circle the items you wish performed by The Company, below and enter total amount above:

### NOTICE TO OWNER

Under the California Mechanics Lien Law, any structural pest control company which contracts to do work for you, any contractor, subcontractor, laborer, supplier or other person who helps to improve your property, but is not paid for his or her work or supplies, has a right to enforce a claim against your property. This means that after a court hearing, your property could be sold by a court officer and the proceeds of the sale used to satisfy the indebtedness. This can happen even if you have paid your structural pest control company in full if the subcontractor, laborers or suppliers remain unpaid.

To preserve their right to file a claim or lien against your property, certain claimants such as subcontractors or material suppliers are required to provide you with a document entitled "Preliminary Notice." Prime contractors and laborers for wages do not have to provide this notice. A Preliminary Notice is not a lien against your property. Its purpose is to notify you of persons who may have a right to file a lien against your property if they are not paid.

## ITEMS

Prefix	Section I	Section II	Further Inspection	Other
1A Sub treatment	430.00	0.00	0.00	0.00
2A Fumigation	1,940.00	0.00	0.00	0.00
2B Termite repair	2,200.00	0.00	0.00	0.00
3A Fungus repair	2,400.00	0.00	0.00	0.00
Total:	6,970.00	0.00	0.00	0.00
Grand Total:	6,970.00			

Property Owner:

Date:

Inspected By:

Date:

Owner's Agent:

Date: